

# Glidermatic GTS 2000

## Handset Key Settings

The following instructions demonstrate how to program or change the key settings on your Gliderol handset, allowing you to select the specific button that operates your door. This procedure will assist in reprogramming your handset from three-button Open/Stop/Close operation to single-button operation. It will also assist in reprogramming your handset to operate multiple doors.

### Step 1:



Carefully remove the light cover by pulling down on the tab near the front of the unit.

### Step 2:

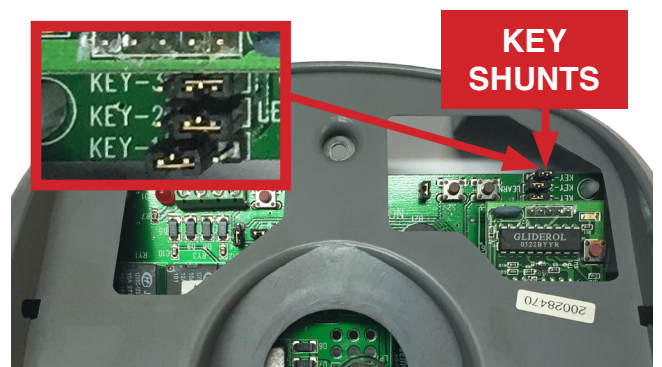

Locate the three key shunts on the main control board. These are labelled KEY-1, KEY-2 & KEY-3 and correspond to the buttons on your remote.

### Step 3: Single Button Operation (1-3 doors)

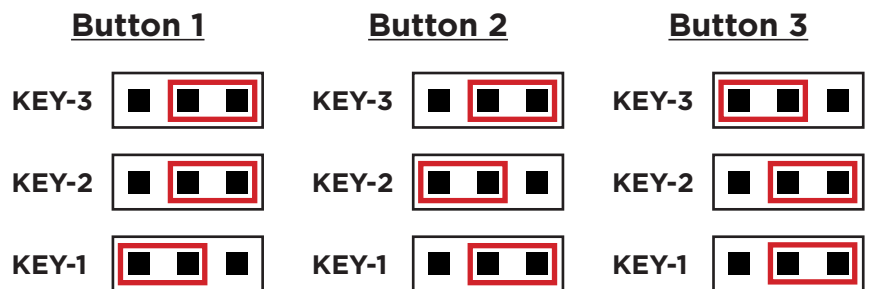
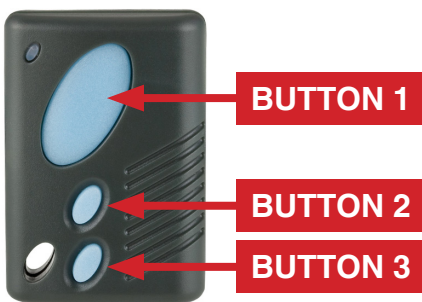

*Note: To operate multiple doors (up to 3) from one remote, simply place a second jumper adjacent to the desired key label*

Relocate the jumper to the first two pins (on the left hand side) adjacent to the desired key label as per the above diagrams. The jumper is the small, black sleeve that slides over the key shunts.

*Note: Changing the key setting on your operator will update all programmed handsets.*

## Glidermatic GTS 2000

### Handset Key Settings cont...

The following instructions demonstrate how to program or change the key settings on your Gliderol handset, allowing you to select the specific button that operates your door. This procedure will assist in reprogramming your handset from three-button Open/Stop/Close operation to single-button operation. It will also assist in reprogramming your handset to operate multiple doors.

#### Step 3: Three Button Operation (1 door only)

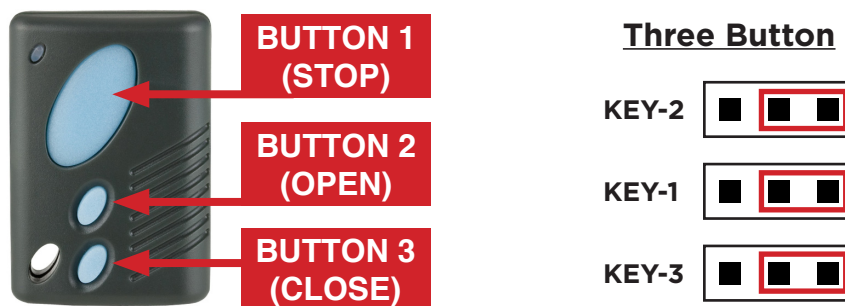

Relocate all jumpers to the last two pins (on the right hand side) adjacent to each key label as per the above diagram. Jumpers are the small, black sleeves that slide over the key shunts.

**Note:** Changing the key setting on your operator will update all programmed handsets.

**Your handset key settings  
are now saved & ready to use!**



Please note, this procedure will simply program the key settings on your Gliderol handset, allowing you to select the specific button that operates your Gliderol Sectional door. To program a new or additional handset please refer to our 'Glidermatic GTS 2000 Programming Additional Handsets' factsheet.