

TM-27 Single Button Handset

Programming New or Additional Handsets

The following instructions demonstrate how to program a new or additional Gliderol Single Button Handset to suit most Gliderol operators pre-1998. Older Gliderol units operate using either Trinary or Binary coding. Trinary units will have a 9 digit code shown inside the operator Control Box, whereas Binary units will have two 8 digit codes inside their Control Box. Please refer to the appropriate set of instructions to successfully program your new Gliderol Single Button Handset.

Trinary Handset Coding - 9 digit code

Step 1:



Remove the cover from the handset to expose the handset circuit board.

Step 2:

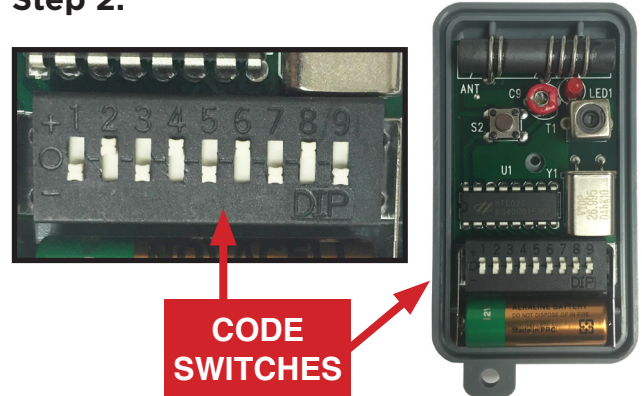

Push the numbered switches 'up' or 'down' to reflect the same code shown inside your existing control box.

**Your handset programming
is now complete!**



Should you require further assistance in programming your Gliderol Single Button Handset please contact your local Gliderol office on 1300 799 177.

TM-27 Single Button Handset

Programming New or Additional Handsets

The following instructions demonstrate how to program a new or additional Gliderol Single Button Handset to suit most Gliderol operators pre-1998. Older Gliderol units operate using either Trinary or Binary coding. Trinary units will have a 9 digit code shown inside the operator Control Box, whereas Binary units will have two 8 digit codes inside their Control Box. Please refer to the appropriate set of instructions to successfully program your new Gliderol Single Button Handset.

Binary Handset Coding - 16 digit code (2 x 8 digit codes)

Binary to Trinary Conversion Table

BINARY SWITCH A	UP	UP	DOWN	DOWN
BINARY SWITCH B	UP	DOWN	UP	DOWN
HANDSET (TRINARY) SWITCH	DOWN	UP	MIDDLE	MIDDLE

Step 1:

Fill out the below table using both of the 8 digit codes inside your control box. Identify if the switch is in the 'UP' or 'DOWN' position.

Binary Switch A

1	2	3	4	5	6	7	8

Binary Switch B

1	2	3	4	5	6	7	8

Step 2:

Using the information collected in Step 1, use the 'Binary to Trinary Conversion Table' to determine your new handset code. **Please note, these numbers are not in sequence** (eg the second digit in your handset code is the result of the third digits from your control box code). The ninth digit is always in the 'DOWN' position.

Handset Code

1	3	4	6	7	2	5	8	9
								DOWN

Using your new 'Handset Code', follow the 'Trinary Handset Coding' instructions to complete your Handset programming.