

Glidermatic GTS+ Optima

Handset Key Settings

The following instructions demonstrate how to program or change the key settings on your Gliderol handset, allowing you to select the specific button that operates your door. This procedure will assist in reprogramming your handset from three-button Open/Stop/Close operation to single-button operation. It will also assist in reprogramming your handset to operate multiple doors.

Step 1:



Carefully remove the light cover by pulling down on the tab near the front of the unit.

Note: The light cover is connected to the units circuit board. Whilst the cover can be unplugged to program your handsets, it must be reconnected to the same two-pin position when completed.

Step 2:

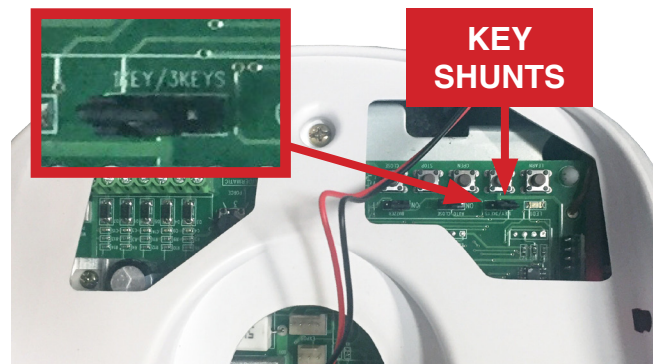

Locate the key shunt on the main control board (behind the 'LIMIT' button). These are labelled 1KEY/3KEYS and correspond to the buttons on your remote.

Step 3: Single Button (1-3 doors)

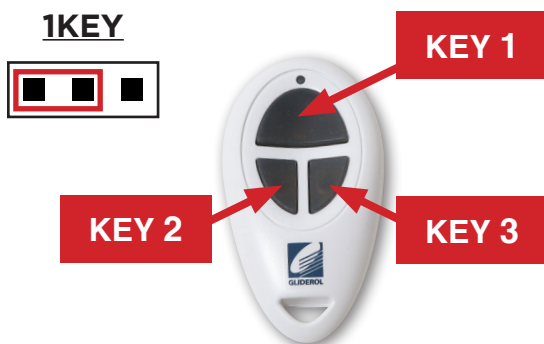

Relocate the jumper to the first two pins (on the left hand side) as per the above diagram. The jumper is the small, black sleeve that slides over the key shunt.

Step 3: Three Button (1 door only)

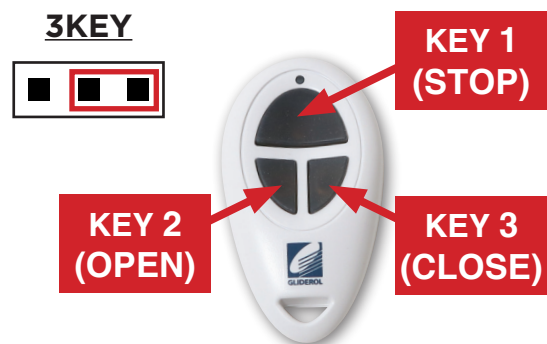

Relocate the jumper to the last two pins (on the right hand side) as per the above diagram. The jumper is the small, black sleeve that slides over the key shunt.

Note: Changing the key setting on your operator will update all programmed handsets.

Glidermatic GTS+ Optima Handset Key Settings cont...

The following instructions demonstrate how to program or change the key settings on your Gliderol handset, allowing you to select the specific button that operates your door. This procedure will assist in reprogramming your handset from three-button Open/Stop/Close operation to single-button operation. It will also assist in reprogramming your handset to operate multiple doors.

Step 4: Single Button (1-3 doors) only

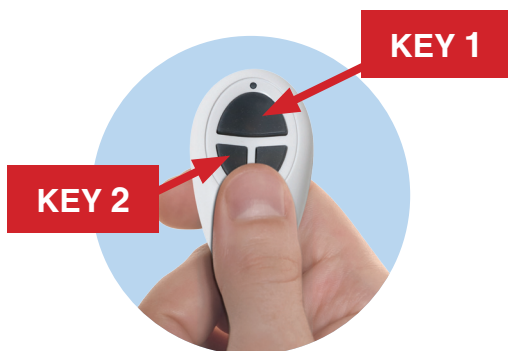

Using an already programmed (paired) remote, press and hold KEY 1 and KEY 2 simultaneously for 3 seconds. The unit will beep to confirm it is now in 'Learn' mode. Press the desired operation key (button you would like to operate that door) and the unit will beep to confirm successful key selection. Unit will automatically exit 'Learn' mode after 3 seconds.

Your handset programming is now complete!



Should you require further assistance in programming your Glidermatic GTS+ Optima handset please contact your local Gliderol office on 1300 799 177.